

# Performance Modes A and B

**E.A.R.S.**

In Performance Mode, any combination of speakers may be employed for use during either mode **A** or **B**, or both together. Performances may include audio media, visual media, live performers, and any or all in combination.

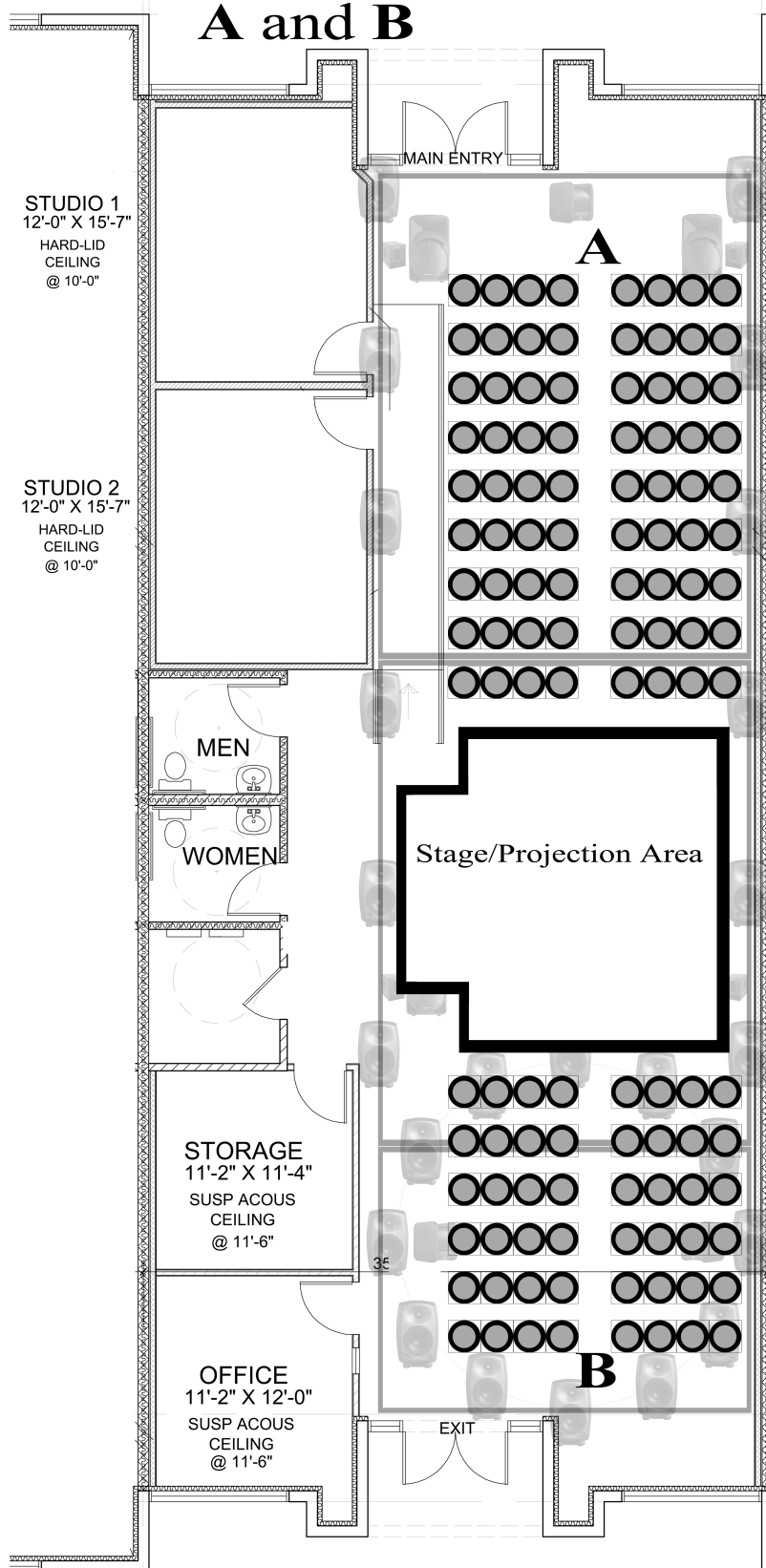

OPEN AREA  
21'-4" X 28'-10"  
SUSP ACOUS  
CEILING  
@ 11'-6"

OPEN AREA  
22'-2" X 42'-11"  
SUSP ACOUS  
CEILING  
@ 11'-6"

-  24 Genelec 8030A
-  4 Genelec 7070A
-  4 Mackie SRM450V2
-  4 Mackie SWA1501